



MODEL 7151 / AGES 13+ / 39 MPH MAX SPEED

7151 150cc FUN KART OWNER'S MANUAL

15516R1 Rev. A
pub. 05/19/2015

THIS VEHICLE IS FOR OFF-ROAD USE ONLY. THIS VEHICLE IS NOT DESIGNED FOR USE ON RENTAL TRACKS OR RACING

BEFORE OPERATING THIS VEHICLE, THE OWNER AND EACH OPERATOR MUST UNDERSTAND THIS VEHICLE WAS NOT DESIGNED OR MANUFACTURED TO MEET SPECIFICATIONS FOR USE ON PUBLIC ROADS, STREETS, HIGHWAYS AND THOROUGHFARES. THE OWNER AND EACH OPERATOR MUST READ AND UNDERSTAND ALL THE INSTRUCTIONS FOR PROPER ASSEMBLY AND SAFE OPERATION, AS WELL AS THE INSTRUCTIONS CONCERNING THE ENGINE AND ALL OTHER PORTIONS OF THE VEHICLE. CHILDREN MUST BE 13+ YEARS OF AGE FOR THIS VEHICLE AND SUPERVISED BY AN ADULT AT ALL TIMES WHEN USING THIS FUN KART. SPEED REDUCTION KITS ARE AVAILABLE FOR ALL VEHICLES. THIS VEHICLE IS NOT A TOY.

ASW, LLC /dba American Sportworks Limited Warranty on Emission Control System

Your warranty rights and obligations

The U.S. Environmental Protection Agency and ASW, LLC /dba American Sportworks (hereinafter "AMERICAN SPORTWORKS") are pleased to explain the emission control system warranty on your Off-Road Vehicle. New off-road vehicles must be designed, built and equipped to meet U.S. EPA standards. AMERICAN SPORTWORKS must warrant the emission control system on your vehicle for 5,000 km, or at least 30 months, whichever comes first, provided that there has been no abuse, neglect or improper maintenance of your vehicle. This off-road vehicle was designed to meet the emission standards for 10,000 km, or five years, whichever comes first.

Your emission control system may include parts such as the carburetor or fuel injection system, the ignition system, catalytic converter and engine computer, if it is equipped. Also included may be hoses, belts, connectors and other emission-related assemblies.

Where a warrantable condition exists, AMERICAN SPORTWORKS will repair your vehicle at no cost to you, including diagnosis, parts and labor.

If an emission-related part on your vehicle is defective, the part will be repaired or replaced by AMERICAN SPORTWORKS. This is your emission control system DEFECTS WARRANTY.

NOTICE! Use of any AMERICAN SPORTWORKS vehicle in any type of competitive event completely and absolutely voids this and all other warranties offered by AMERICAN SPORTWORKS.

Owner's warranty responsibilities

As the vehicle owner, you are responsible for the performance of the required maintenance listed in your owner's manual. AMERICAN SPORTWORKS recommend that you retain all receipts covering maintenance on your vehicle, but AMERICAN SPORTWORKS cannot deny warranty solely for the lack of receipts or for your failure to ensure the performance of all scheduled maintenance.

You are responsible for presenting your vehicle to the AMERICAN SPORTWORKS dealer as soon as a problem exists. The warranty repairs should be completed in a reasonable amount of time, not to exceed 30 days.

As the vehicle owner, you should be aware that AMERICAN SPORTWORKS may deny your warranty coverage if your vehicle or a part has failed due to abuse, neglect, improper maintenance or unapproved modifications.

If you use your vehicle in any type of competitive event, this warranty is immediately and completely void.

If you have any questions regarding your warranty rights and responsibilities, you should contact ASW, LLC /dba American Sportworks, 7625 Disalle Blvd, Fort Wayne, IN 46825 (800-643-7332) or the U.S. Environmental Protection Agency, 2000 Traverwood Drive, Ann Arbor, MI 48105.

AMERICAN SPORTWORKS warrants that each new off-road vehicle:

A. is designed, built and equipped so as to conform at the time of initial retail purchase with all applicable regulations of the United States Environmental Protection Agency, and;

B. is free from defects in material and workmanship which cause such vehicle to fail to conform to applicable regulations of the United States Environmental Protection Agency for the periods specified above.

I. COVERAGE. Warranty defects shall be remedied during customary business hours at any authorized AMERICAN SPORTWORKS dealer located within the United States of America in compliance with the Clean Air Act and applicable regulations of the United States Environmental Protection Agency. Any part or parts replaced under this warranty shall become the property of AMERICAN SPORTWORKS.

II. LIMITATIONS. This Emission Control System Warranty shall not cover any of the following:

A: Repair or replacement as a result of

- (1) accident,
- (2) misuse,
- (3) repairs improperly performed or replacements improperly installed,
- (4) use of replacement parts or accessories not conforming to specifications set forth by AMERICAN SPORTWORKS, which adversely affect performance and/or
- (5) use in competitive racing or related events.

B: Inspections, replacement of parts and other services and adjustments required for required maintenance.

C: Any vehicle equipped with an odometer or hour meter on which the odometer mileage or hour meter reading has been changed so that actual mileage cannot be readily determined.

III. LIMITED LIABILITY

A. The liability of AMERICAN SPORTWORKS under this Emission Control System Warranty is limited solely to the remedying of defects in material or workmanship by an authorized AMERICAN SPORTWORKS dealer at its place of business during customary business hours. This warranty does not cover inconvenience or loss of use of the vehicle or transportation of the vehicle to or from the AMERICAN SPORTWORKS dealer. AMERICAN SPORTWORKS shall not be liable for any other expenses, loss or damage, whether direct, incidental, consequential or exemplary arising in connection with the sale or use of or inability to use the AMERICAN SPORTWORKS vehicle for any purpose. Some states do not allow the exclusion or limitation of any incidental or consequential damages, so the above limitations may not apply to you.

B. No express emission control system warranty is given by AMERICAN SPORTWORKS, except as specifically set forth herein. Any emission control system warranty implied by law, including any warranty of merchantability or fitness for a particular purpose, is limited to the express emission control system warranty terms stated in this warranty. The foregoing statements of warranty are exclusive and in lieu of all other remedies. Some states do not allow limitations on how long an implied warranty lasts, so the above limitations may not apply to you.

C. No dealer is authorized to modify this Limited Emission Control System Warranty issued by AMERICAN SPORTWORKS.

IV. LEGAL RIGHTS. This warranty gives you specific legal rights, and you may also have other rights which vary from state to state.

V. This warranty is in addition to the AMERICAN SPORTWORKS limited vehicle warranty.

VI. ADDITIONAL INFORMATION. Any replacement part that is equivalent in performance and durability may be used in the performance of any maintenance or repairs. However, AMERICAN SPORTWORKS is not liable for these parts. The owner is responsible for the performance of all required maintenance. Such maintenance may be performed at a service establishment or by any individual. The warranty period begins on the date the off-road vehicle is delivered to an ultimate purchaser.



limited warranty

Fun Karts

Limited Warranty: American SportWorks (hereinafter referred to as “ASW”) hereby warrants to the original purchaser that the frame, component parts and engine of your new ASW Fun Kart will be free from defects in material and workmanship. Your period of warranty is thirty (30) days from date of purchase (except as noted below). The frame is warranted for ninety (90) days and one (1) year on certain engines. On those engines which carry a separate manufacturer’s warranty, they are not covered by this ASW warranty. Please refer to the engine manufacturer’s warranty policy included with your ASW product for its warranty repair requirements and procedures. The engine manufacturer’s warranty may be for a longer period of time than a one (1) year period.

ASW Warranty Responsibilities: ASW, if notified of a defect in material or workmanship during the period of warranty, will repair or replace, at its option, defective parts covered by this warranty at no charge, other than the reasonable cost for the transportation of the component(s). ASW will also agree to pay reasonable charges for labor, if necessary, to perform a warranty repair.

Warranty Claim Requirements and Procedures: In order to be able to claim under this warranty the original purchaser must maintain and operate the vehicle in accordance with the instructions provided in the Operator’s Manual, engine manual, the supplements thereto, and labels affixed to the vehicle. Additionally, within (10) days of the discovery of an alleged defect, the original purchaser must contact ASW’s Customer Service Department at 1-800-643-7332, 7625 DiSalle Boulevard, Fort Wayne, IN 46825 or via the internet at www.amsportworks.com. The repair or replacement of any part or parts under this Limited Warranty shall not extend the term of the warranty beyond the original term as set forth above.

General Exclusions: This limited warranty does not cover component failure or damage caused by any of the following: abnormal strain or stress, neglect; abuse; improper assembly of components which were supplied in the factory sealed carton after the vehicle left ASW; improper maintenance, modifications, damage caused by use of non ASW accessories, improper use of the vehicle, including, but not limited to racing, jumping, stunt driving, or any other uses prohibited by the Operator’s Manual. Additionally, this warranty does not cover vehicles which are leased, rented, or used at a concession track.

Specific Exclusions: This limited warranty does not apply to components which are subject to normal wear and tear. These items include, but are not limited to, the tires, battery, brakes, throttle, shift and brake cables, drive belt, the torque converter system, chain, seat, lights, fasteners, decals, or body panels and natural cosmetic discoloration of material due to ultraviolet light. Downtime, pick-up and delivery charges are not covered by this warranty. This warranty does not apply to select engines which are covered by a separate manufacturer’s warranty.

NO IMPLIED WARRANTY OF FITNESS OR MERCHANTABILITY: THERE ARE NO WARRANTIES WHICH EXTEND BEYOND THE DESCRIPTION ON THE FACE HEREOF. SPECIFICALLY, ASW MAKES NO OTHER WARRANTY OF ANY KIND, EXPRESSED OR IMPLIED. ALL WARRANTIES OF MERCHANTABILITY AND FITNESS FOR A PARTICULAR PURPOSE WHICH EXCEED THE OBLIGATIONS AND TIME LIMITATIONS SPECIFIED IN THE WARRANTY ABOVE ARE HEREBY DISCLAIMED BY ASW AND EXCLUDED FROM THIS WARRANTY. ADDITIONALLY, THIS WARRANTY EXCLUDES ANY INCIDENTAL OR CONSEQUENTIAL DAMAGES, INCLUDING BUT NOT LIMITED TO LOSS OF USE. SOME STATES DO NOT ALLOW A MANUFACTURER TO EXCLUDE OR LIMIT INCIDENTAL OR CONSEQUENTIAL DAMAGES AND, THEREFORE, THE ABOVE EXCLUSION MAY NOT APPLY TO YOU.

SOME STATES DO NOT ALLOW LIMITATIONS ON HOW LONG AN IMPLIED WARRANTY WILL LAST. IT IS POSSIBLE THAT THE ABOVE LIMITATION MAY NOT APPLY TO YOU. THIS WARRANTY GIVES YOU SPECIFIC LEGAL RIGHTS, AND YOU MAY ALSO HAVE OTHER LEGAL RIGHTS, WHICH VARY, FROM STATE TO STATE.

Warranty Service: To obtain warranty service you must return your ASW product to the local authorized dealer or service center, inform them of your warranty problem and provide proof of purchase before any warranty service can be provided. The authorized dealer or service center will inspect the product to determine what repairs or parts are needed and whether they are covered under this warranty. To locate the authorized dealer or service center nearest you please call ASW customer service at 800-643-7332, or visit our website at www.amsportworks.com for more information.

EPA Requirements: This product complies with all applicable EPA Emissions and, Evaporative requirements. Included with your product’s documents are copies of ASW’s “Emission Control System Warranty Statement”. If your vehicle has a fuel tank mounted remotely from the engine, you will be provided with an “Evaporative Emissions Warranty Statement”.

TABLE OF CONTENTS

Emissions Warranty i
 ASW Limited Warranty ii

SECTION 1 INTRODUCTION

Forward / Emissions Warranty / Cell Phone Use 1

SECTION 2 OPERATION

Kart Operation 2
 Kart Features and Locations 4

SECTION 3 SERVICE

Replacement Parts 5
 Air Cleaner 5
 Engine lubrication 5
 Spark Plug 6
 Carburetor Adjustment 6
 Cleaning Instructions 6
 General Lubrication 6
 Chain Lubrication & Adjustment 6
 Shock Adjustment / Shifter Adjustment 7
 Storage Instructions 7

SECTION 4 MAINTENANCE

Wheel Replacement / Front Wheel Alignment 8
 Optional Speed Reducer installation 8
 Specifications and Electrical Schematic 9

YOUR VEHICLE IDENTIFICATION NUMBER (VIN)

the VIN plate is located on a bar behind the drivers seat

The VIN number begins and ends with a star. **THIS CHARACTER IS NOT IMPORTANT**

Making sure your VIN is noted correctly greatly reduces any delays in getting help with parts, accessories or any warranty work.

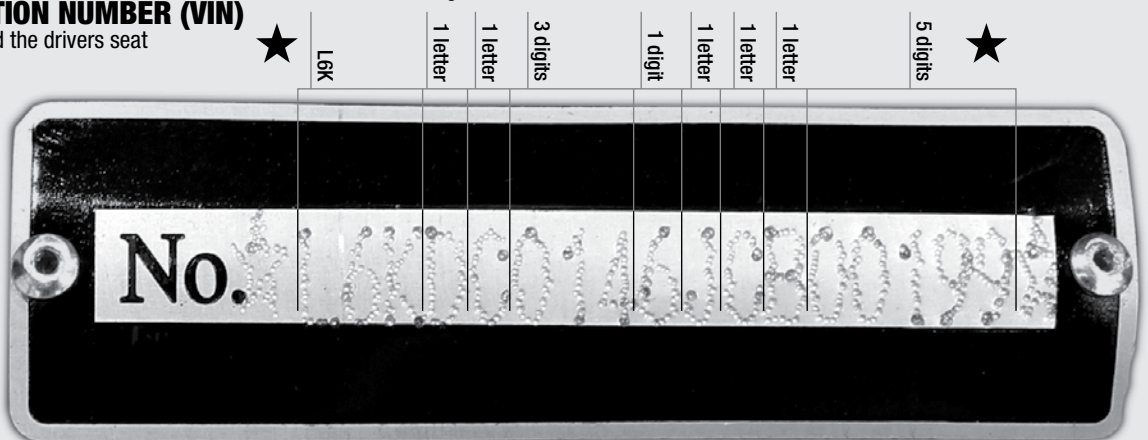

MODEL: 7151 CARBIDE

17 DIGIT VIN: **L 6 K** [] [] [] [] [] [] [] [] [] [] [] [] [] [] []
letter / digit / letter letter letter digits digit letter letter letter digits

FORWARD

Congratulations on the purchase of your American SportWorks / ASW Fun Kart. Please take a few moments to get well acquainted with your vehicle by reading the Operator Safety Manual as well as this Owners Manual / Parts Guide. Before operating this vehicle, the owner, and each operator, must understand that this vehicle was not designed or manufactured to meet specifications for use on public roads, streets, highways and thoroughfares. The owner, operator(s) and passenger(s) must read and understand all the instructions for proper assembly and safe operation, as well as the instructions concerning the engine and all other portions of the vehicle as described and illustrated in this manual, the Operator Safety Manual and on the included Kart Safety DVD. Children must be 13 years of age or older and supervised by an adult at all times when using the vehicle. This vehicle is not a toy.

Be sure to follow the recommended maintenance schedule and service your machine accordingly. Preventative maintenance is extremely important to the safe operation and longevity of your vehicle.

Inexperienced and first time drivers are urged to seek instruction from a dealer or qualified instructor before and during the initial use of this vehicle. It is also recommended to practice in a large open area to become familiar with the operation of the machine. This vehicle is designed for drivers and riders 13 years and older.

For more information on American Sportworks and its products visit our website at www.amsportworks.com.

New Vehicle Limited Warranty

For a detailed description of warranty coverage for your vehicle, refer to the Warranty section of the Owners Manual / Parts Guide as supplied with the vehicle, or go to www.amsportworks.com.

Emissions Warranty

For a detailed description of the emissions warranty for your vehicle, refer to the Emissions Warranty section of the Owners Manual / Parts Guide as supplied with the vehicle, or go to www.amsportworks.com.

Cell Phone Use

The use of Mobile Communications Equipment has become increasingly important and prevalent in both personal and business affairs. Drivers must not compromise their own, or others safety when using such equipment. ASW recommends against the use of any handheld device while driving this vehicle.

We hope you will have a fun, safe experience with our products and thank you again for choosing an American SportWorks Fun Machine.

Your vehicle has been supplied with:

- **OPERATOR SAFETY MANUAL (Book 1)**
- **OWNERS MANUAL / PARTS GUIDE (Book 2)**
- **KART SAFETY DVD**

If any of these items are missing or were not supplied with your vehicle, please contact American SportWorks at 800-643-7332 or visit our website at www.amsportworks.com.

safety section

SOME WORDS ABOUT SAFETY

Please thoroughly read and understand the Safety Section outlined in the Operator Safety Manual supplied with this Fun Kart along with the Kart Safety DVD. If, for some reason, you did not receive these items please contact American Sportworks or visit our website at www.amsportworks.com.

WARNINGS AND CAUTIONS

 This is the safety alert symbol. When you see this symbol on your machine or in this manual, be alert to the potential for personal injury.

Read and follow all instructions in the Operator Safety Manual, this manual and any accompanying manuals before attempting to operate this vehicle. Make sure to view the Kart Safety DVD.

WARNING

Indicates a potential hazard that could result in severe personal injury or death

CAUTION

Indicates a potential hazard which may result in personal injury or damage to the machine.

NOTE: Use of the word "NOTE" will alert you to key information or instructions.

KART OPERATION

A. Operation controls

⚠ WARNING

Do not attempt to start or operate the engine until completely familiar with the location and use of each control necessary to operate this vehicle. The operator must know how to stop this machine before starting and driving it.

B. Throttle

The right foot pedal is the throttle and controls the speed of the kart. As the engine speed increases above idle, the driver pulley automatically engages the drive belt and moves the vehicle forward. To disengage the driver pulley at any time, allow the throttle to return to the idle position.

⚠ WARNING

Every time, prior to starting the engine, check the throttle assembly to ensure that when the pedal is pushed all the way forward the assembly is working smoothly and returns to idle when released. Do not operate this unit if pedal or engine throttle linkage fail to return to the idle position. If unable to correct the problem through lubrication, adjustment or replacement of worn parts, contact your dealer for assistance.

C. Brake

The brake is controlled by the left foot pedal (See Figure below). Applying pressure to the pedal draws the brake pads against the brake disc at the rear axle and slows or stops the kart. The locking lever can be applied to act as a park brake and should remain applied during starting and engine warming (choke cycle). See I. Park Brake for more instruction.

D. Fuel Valve (see fig. D1)

The manual valve is mounted to the bottom of the fuel tank and provides the added feature of a “reserve” position which provides access to a reserve fuel supply allowing additional driving range to get to a fuel filling station should the main fuel supply be used completely.

NOTE: Turn fuel valve to OFF position during transport

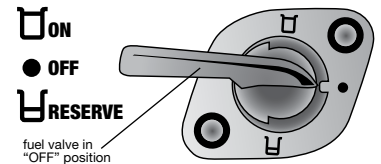

fig. D1

E. Engine Starting (see fig. E1)

For parental control and added security, this unit is equipped with a keyed ignition switch. To start the unit, ensure both Engine Stop Switches are in the RUN position. **(NOTE: Your Fun-Kart is equipped with (2) engine stop switches, one located on the dash and one located on the swing arm. BOTH switches must be in the “RUN” position for the engine to start.)** Place the unit in the NEUTRAL gear. Fasten seatbelt and place one foot on the brake pedal. Pump the throttle pedal several times to ensure that the pedal operates and returns smoothly. Apply choke by pulling out and holding the choke cable located under the driver’s seat. Turn ignition key fully clockwise and hold to start the engine. (Caution: Do not let the engine turn over for more than 5 seconds at a time as this may cause starter damage). Once the engine starts, allow the key to return to the run position. Adjust the choke by pushing it in slowly. If the engine starts to run rough, pull the choke control out slightly and then continue to push the choke control in after the engine can accept small applications of the gas pedal. Continue this process until the choke control is pushed all the way in (fully “OFF”). This may require a period of several seconds to several minutes, depending on the air temperature. Before driving this vehicle, test that the ignition switch will turn off the engine. With the engine running, turn the ignition key counter-clockwise to the “OFF” position to shut down the engine.

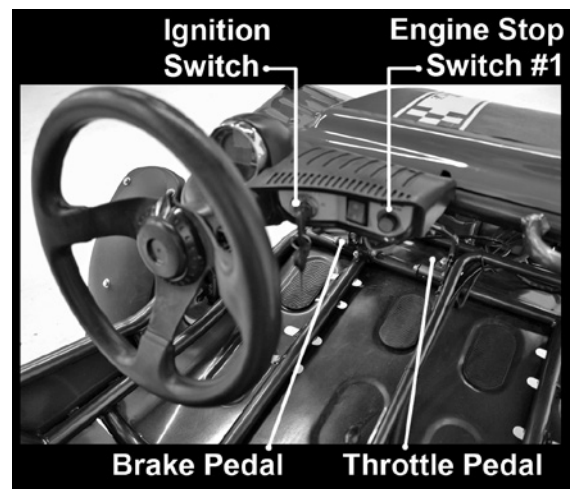

fig. E1

F. Engine Stop Switch (see fig. F1)

Before driving this vehicle, test each Engine Stop Switch to ensure that it is operating properly. With the engine running, switch the Engine Stop Switch to the STOP position to shut down the engine. (The STOP position may be identified on the switch by the word “STOP”, the word “OFF”, or the symbol “O”.) Repeat the process for the other Engine Stop Switch. With the engine running, turn the ignition key to the “OFF” position to shut down the engine.

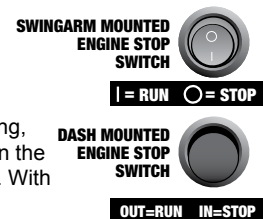

fig. F1

G. Seat Adjustment

The unit is equipped with an adjustable driver's seat. To adjust, lift the lever just in front of the seat bottom and move the seat either forward or backward. Release the lever at the desired seat location, ensuring that it snaps back into place to lock the seat in position.

⚠ WARNING

Never operate this vehicle when the seat is not securely locked into position. Serious injury or death could occur due to loss of control. Always make seat adjustments with the vehicle fully stopped and the engine shut off.

H. Occupant Restraints

This kart is equipped with 3 point retracting seat belts. Insert the metal tongue into the buckle until it is securely attached. Final adjustments should be made with the plastic tension stop such that the belt is against the shoulder and chest with no excess slack.

⚠ WARNING

Operating this kart without your seat belt could cause you to be thrown from the kart, causing serious injury or death.

I. Rear Cargo Rack

This kart is equipped with a rear cargo rack. The rack should be used for transporting small items, however, all items MUST be securely tied down with adequate straps or cords. Additionally, never exceed the rated load of 25lbs.

⚠ WARNING

Failure to properly tie down loose items and exceeding the maximum rating of the cargo rack may cause serious injury or death.

J. Gear Selection

This kart is equipped with a Drive / Neutral / Reverse transmission. To shift gears, bring the kart to a complete stop and let the engine RPM drop to the idle level. Move the shift lever to the desired gear and gently depress the throttle pedal.

⚠ CAUTION

Damage to the fun kart will occur if the unit is shifted into a different gear while the kart is still in motion. ALWAYS bring the vehicle to a complete stop before selecting a different gear.

K. Steering Adjustment (see fig. K1)

This kart is equipped with an adjustable tilt steering feature. To adjust, loosen the adjusting knob (A) until the steering column can move up and down. Select the appropriate setting and re-tighten the adjusting knob.

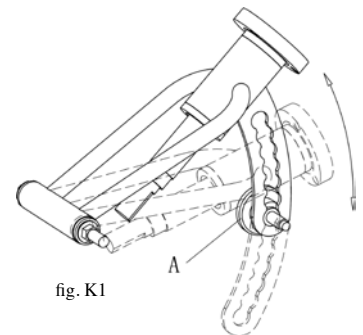

fig. K1

⚠ WARNING

Do not operate the vehicle without ensuring that the steering adjustment knob is securely tightened. Serious injury or death could occur due to loss of control or rollover.

L. Park Brake (see fig. L1)

The park brake should be applied during starting, engine warming (choke cycle), and anytime the vehicle is parked and/or left unattended. The park brake is set by applying pressure to the brake pedal and latching the locking lever over the latch pin.

To apply the park brake fig. L1

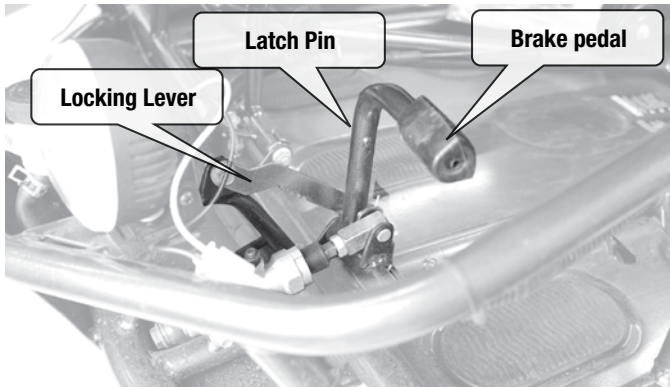

Parking brake not engaged

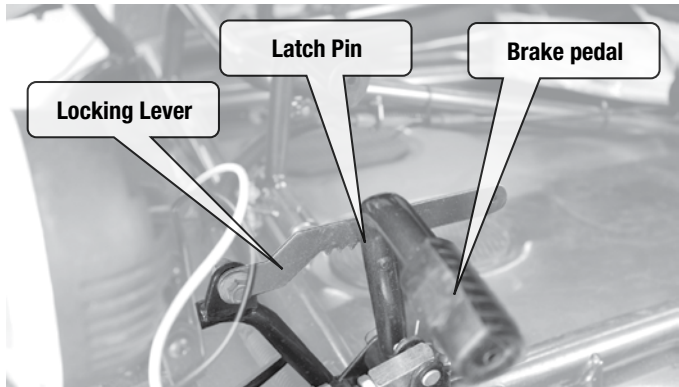

Parking brake engaged

KART FEATURES AND LOCATIONS

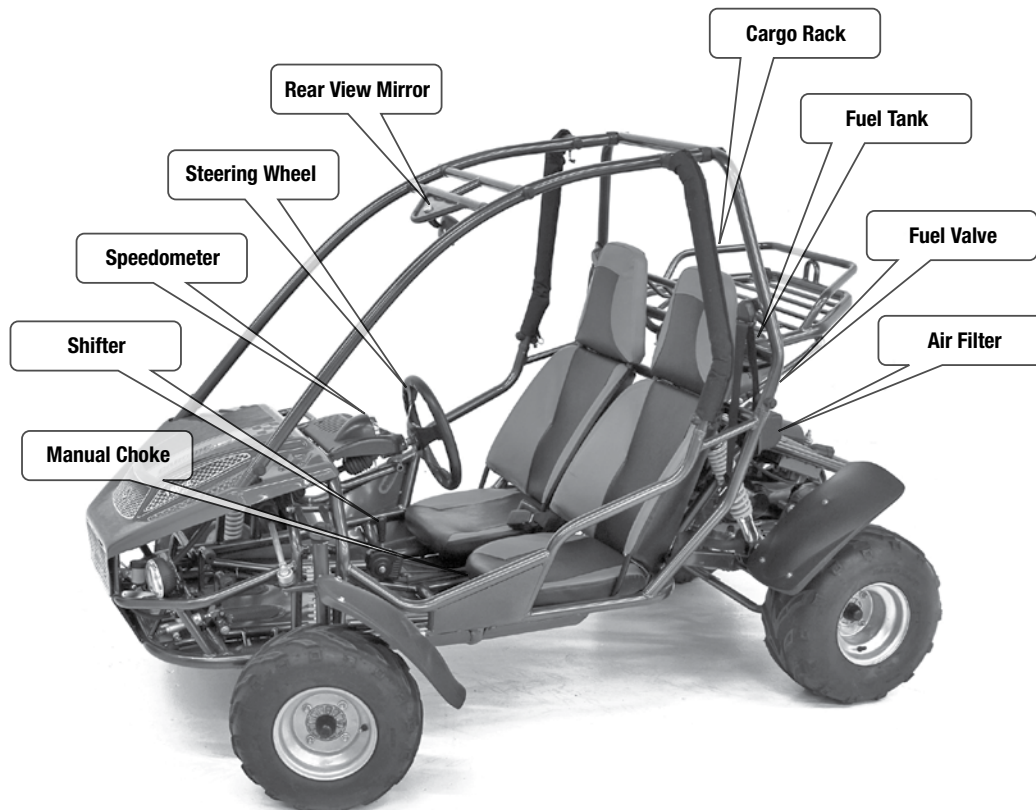

CAUTION

NEVER use E-15 or E-85 fuel or blends with Ethanol content in excess of 10%. Ethanol blends in excess of 10% will cause damage to the engine and void manufacturer warranty

- a. Use regular unleaded 87 octane gasoline with up to a 10% ethanol blend.
- b. This engine supplied with this Fun-Kart is NOT designed for Flex Fuel operation.

REPLACEMENT PARTS AND SERVICE

Most replacement parts are typically available from your dealer. Because of immediate availability and convenience, it is recommended that replacement parts be ordered from an authorized dealer. Take this manual and all supplements to the dealer when ordering parts in person.

If replacement parts are not available from a dealer, they may be ordered directly from American Sportworks by contacting ASW at 1-800-643-7332 or online at www.amsportworks.com. Orders may be subject to a minimum fee. A listing of authorized service center locations in your area is also available from our Customer Service department.

Record the Vehicle Identification Number (VIN) in the spaces provided at the front of this manual. The VIN can be found on the crossbar, behind the seat.

SERVICE

A. Air Cleaner *(see fig. A1)*

This unit is equipped with a paper style air filter element and should be replaced after every 20 hours of operation (Ref Figure).

NOTE: Operation in unusually dusty conditions may require more frequent replacement.

- 1) Remove the air cleaner cover (1) by removing the Phillips head screws.
- 2) Clean any excess dirt, oil, or dust from the air cleaner box with a mild detergent and water solution.
- 3) Thoroughly dry the air box
- 4) Replace the air cleaner element (2)
- 5) Carefully align the gasket between the air box halves during re-assembly

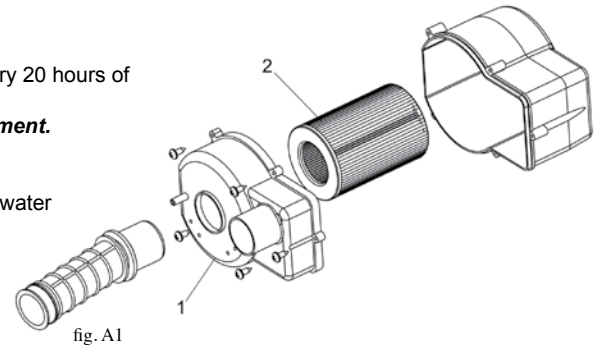

fig. A1

B. Engine Lubrication *(see fig. B1)*

You **MUST** change the oil in the crankcase after the first 5 hours of operating a new engine. The engine oil should then be changed every 20 hours of use thereafter. This will insure proper lubrication of the internal parts and prevent costly repairs due to excessive wear.

⚠ CAUTION

This unit has been shipped with special BREAK-IN oil pre-filled in the engine crankcase. This oil MUST be changed after 5 hours of operation. Replace with SAE 10W40 weight motor oil as described in the following section.

⚠ WARNING



Used oil MUST be disposed of at a proper collection center

- a. Remove the drain plug located on the bottom of the right rear side of engine. Elevating the front of the kart slightly will help drain all of the oil.
- b. The oil should be emptied into suitable container for recycling.
- c. Remove and clean the oil screen.
- d. With the oil completely drained, replace the drain plug and tighten securely.
- e. Place the kart back onto a flat surface to level the engine, and Re-fill the crankcase with 30oz of SAE 10W40 motor oil.
- f. Check the oil level using the dipstick attached to the oil plug cap. Be sure to check the oil level before each use of the kart. Add oil when necessary to keep the oil level between the bottom of the dipstick and the "O" mark.

NOTE: Oil level should be checked by dipping the oil level stick into the crankcase WITHOUT screwing the cap in.

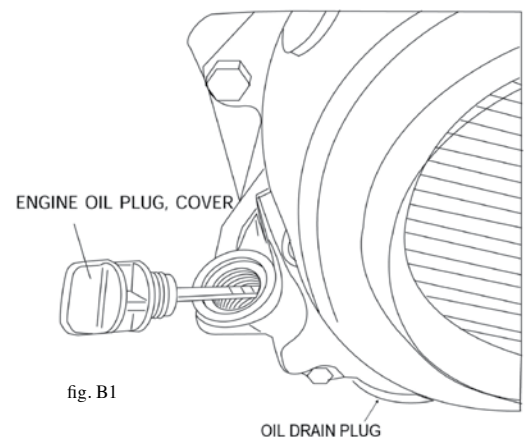
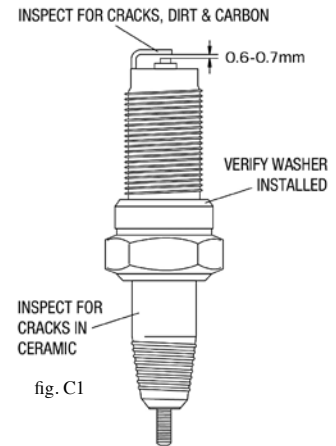

fig. B1

C. Spark Plug (see fig. C1)

- a. Remove the spark plug and inspect it each time you change the oil (Use a spark plug wrench). The electrodes should be kept clean and free of carbon. The presence of carbon or excess oil will greatly reduce engine performance. If possible, check the spark plug gap (area between the electrodes) using a wire feeler gage or spark plug gap tool.
- b. Correct gap is 0.6 - .07mm
- c. Before installing the spark plug, coat the threads lightly with graphite lubricant to ensure easier removal of the plug in the future.
- d. Spark plug should be replaced once a year for optimum engine performance.



D. Carburetor Adjustment (see fig. D1)

All the necessary carburetor adjustments have been made at the factory, and the recommended settings are correct for most applications. To adjust the engine idle setting on the carburetor:

- a. Allow the engine to warm up for 5-10minutes
- b. Using a Phillips screwdriver, adjust the idle screw (B) until the engine settles at approximately 1400RPM

NOTE: For further carburetor adjustments, refer to the Service Manual available on our website at www.amsportworks.com, for purchase from your Dealer or by calling ASW's customer service.

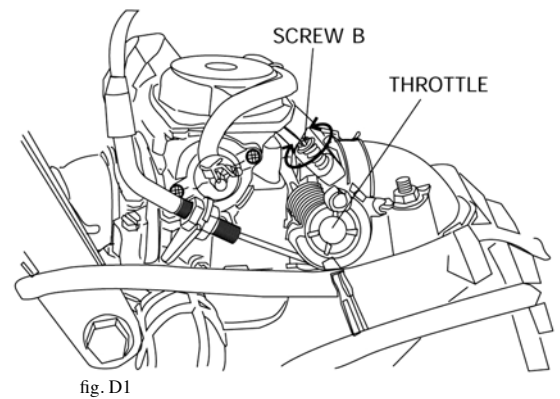

E. Cleaning Instructions

Keep your kart clean by using a clean rag and a mild detergent and water solution. Wipe off all dirt and oil from around the controls. Wipe off any spilled fuel and oil. Keep the engine clean and clear of foreign objects, especially those around the air intake fan and air inlet ductwork.

F. General Lubrication

Lubricate the vehicle at least every 90 days, and more often, if the kart is used daily or in unusually dusty conditions. Lubrication of the front suspension should be performed by adding fresh axle grease, with a grease gun, to the fittings located on each A-Arm.

G. Chain Lubrication and Adjustment (see fig. G1)

For optimum chain life, regular lubrication with a spray on chain lubricant should be performed on a regular basis. (Ref Figure below)

A new chain will have initial stretch and therefore will require adjustment. The first chain adjustment should be made after the first 2 hours of use. If the chain has more than 1/2" of slack or "flex" then it will require adjustment. To adjust:

- a. Loosen Nut (1).
- b. Adjust nut (2) on the underside of the tube.
- c. Re-tighten Nut (1) until the proper chain tension is achieved.

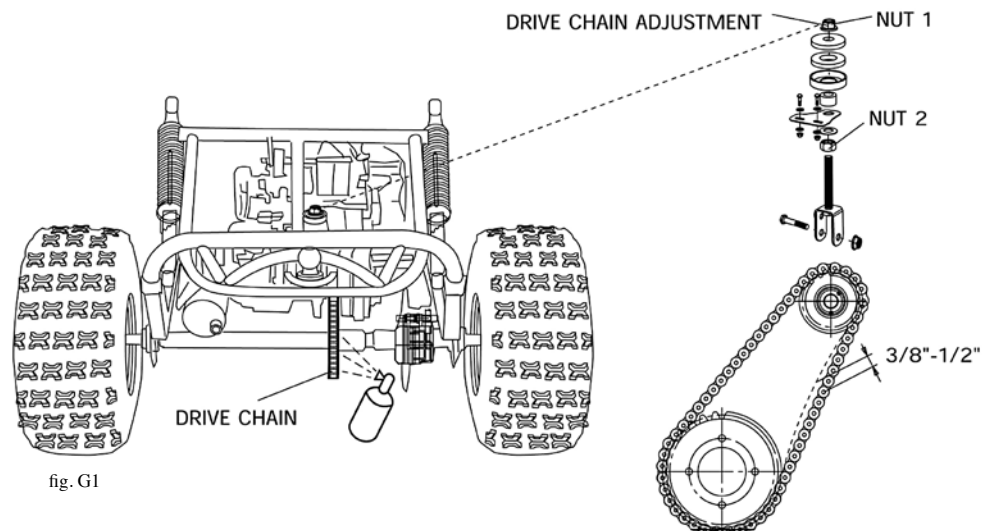

H. Adjustment of Front and Rear Shock (see fig. H1)

There are five adjustable positions on each shock. The center notch is the default position as set by the manufacturer (Ref Figure). Use a round nut wrench to adjust the shock.

To **INCREASE** the shock stiffness, rotate the ring to the highest (longest) setting.

To **DECREASE** the shock stiffness, rotate the ring to the lowest (shortest) setting. Shock stiffness adjustments should be made based on the overall weight of the rider and occupant.

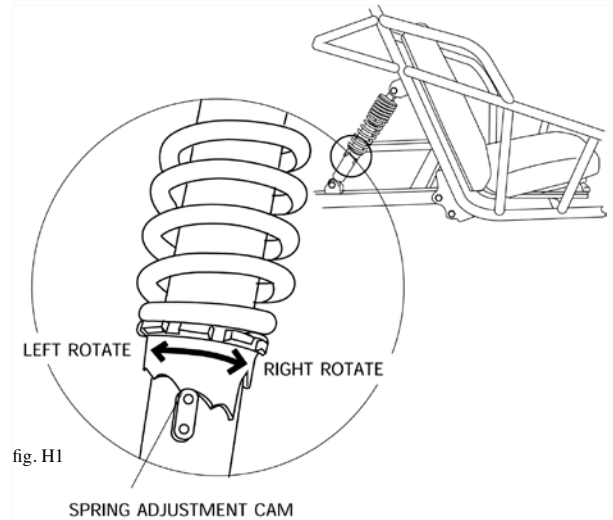

I. Shifter Adjustment (see fig. I1)

Your unit may require an occasional adjustment in the shift cables due to typical stretch found during normal operation of the kart. To make shift adjustments, ensure that engine is off and spark plug cap is removed. Refer to the following procedure:

- Push the shift lever to the "D" position
- Check the restriction control disc found just behind the oil level dipstick to ensure that it has rotated forward all the way (looking for any slack in control cable #1)
- Loosen adjustment nuts #1 and #2, pulling the housing to draw the cable tight. Re-tighten the nuts when the cable is properly tensioned.
- Shift the lever to the "R" position and check the control disc to ensure that it has rotated full towards the rear of the kart.
- Loosen adjustment nuts #3 and #4, pulling the cable housing to draw the #2 control cable tight.
- Re-tighten nuts #3 and #4 when the cable is properly tensioned.

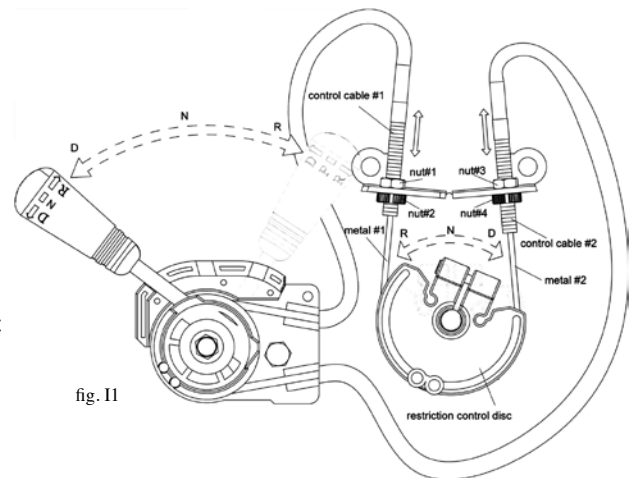

J. Storage Instruction

If you plan to store (and not operate) your kart for a period in excess of 30 days, or at the end of each driving season, the unit should be set up for storage as follows:

- Drain fuel tank and carburetor by allowing the engine to run completely out of fuel.
- Lubricate the engine cylinder by removing the air cleaner and spraying an engine fogging oil through the carburetor.
- Do NOT save or store gasoline over the winter. Using old gasoline, which will deteriorate from storage, will make the engine difficult to start and affect the performance of the engine.
- Remove the battery from the unit and apply a periodic trickle charge to maintain the battery at a proper voltage level for the next riding season.
- To protect the paint, plastics and upholstery, it is a good idea to keep the unit covered when not in use.

⚠ CAUTION

If this unit is stored outside, the air box could collect rainwater. To prevent water from damaging the engine, any trapped water should be drained prior to each use by opening the drain tube located on the bottom side of the air box.

GENERAL MAINTENANCE

A. Front Wheel Replacement *(see fig. A1)*

Do not disassemble the castle nuts when you replace the front wheels. It is only necessary to remove the 4 lug nuts to remove the wheel. (See Figure) Tighten the nuts securely after replacing the wheels.

B. Rear Wheel Replacement *(see fig. A1)*

Do not disassemble the castle nuts when you replace the rear wheels. It is only necessary to remove the 4 lug nuts to remove the wheel. (See Figure) Tighten the nuts after replacing the wheels.

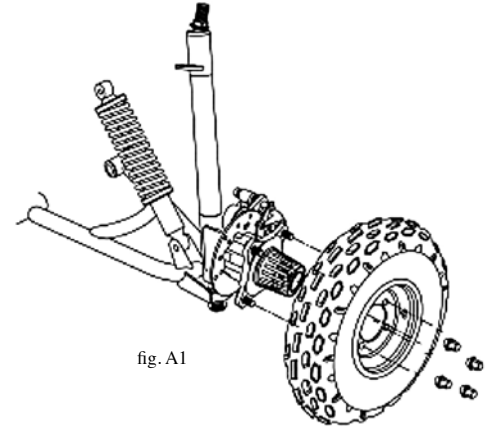

C. Front Wheel Alignment *(see fig. C1)*

The front wheels should be set with a “toe-in” from 1/8” to 1/4”. At the centerline of the tires, measure the Distance A and the Distance B. For proper toe adjustment, Dimension A should be 1/8” – 1/4” greater than Dimension B.

To make adjustments:

- Loosen the lock nuts on both sides of Front Tie Rods.
- Ensure the steering wheel is centered, and adjust Dimension B by equally rotating the tie rods in or out with a 12mm wrench.
- After adjusting to the desired length, tighten the lock nut against the rod end.
- Recheck the dimensions for proper alignment.

D. Optional Speed Reduction Installation *(see fig. D1)*

This kart has been equipped with provision for a speed limiter to reduce the overall speed of the unit to 20mph max. This kit is available from your dealer or directly from American SportWorks by calling customer service.

To install the speed limiter:

- Remove the electrical control box cover located on the rear swing arm, just next to the air box, using a Phillips screwdriver.
- Locate the CDI (black box with 2 wire plugs)
- Unplug the old CDI and replace with the new Rev Limited CDI provided in the kit.
- Replace the electrical box cover, being careful not to damage or crush any wires and connections.

NOTE: Keep the original CDI so that the kart can be changed back to the original factory setting if desired.

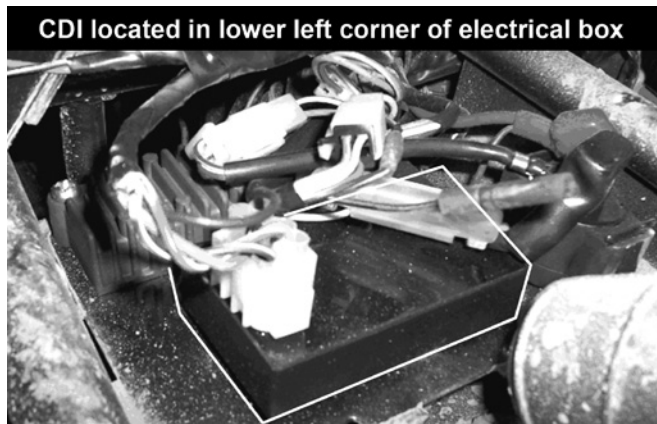

fig. D1

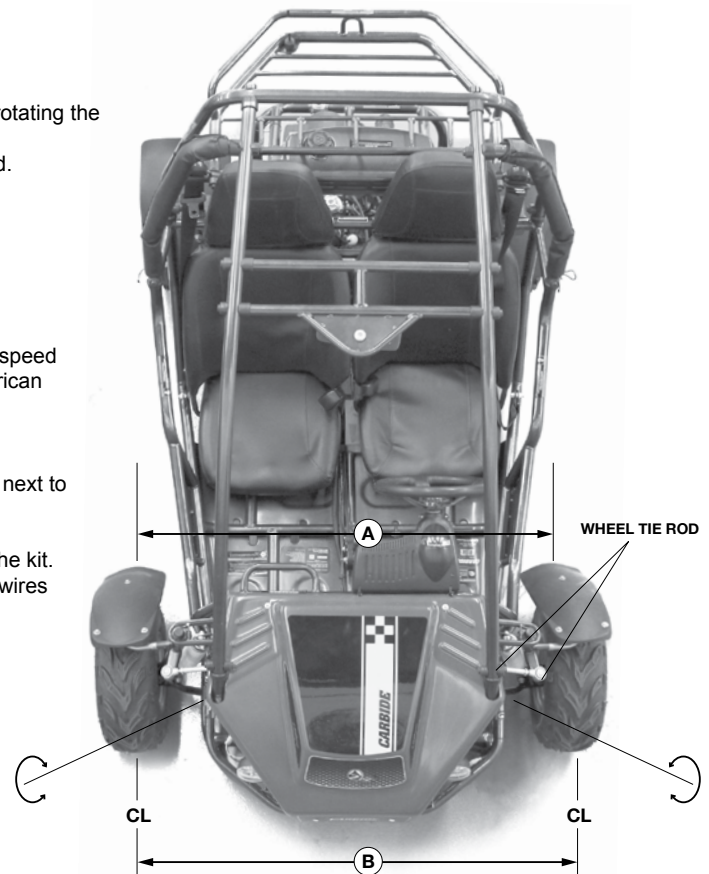

fig. C1 Toe Adjustment Diagram

CAUTION

Prevailing torque type locknuts must be replaced with new after the old locknuts are removed.



7151 SPECIFICATIONS

ENGINE	
Type	Single Cylinder, 150cc, Air Cooled, 4 cycle
Power (BHP @ RPM)	≈ 9.0 @ 7500
Torque (Ft-lbs @ RPM)	≈ 13.0 @ 5500
Starting System	Keyed Electric / CDI
Air Filtration	Single Element
Exhaust System	Muffler with Heat Shield
Fuel Capacity	1.75 gal
Oil Capacity	30 oz. 10W40
Spark Plug	NGK C7HSA
TRANSMISSION	
Type: Dual Wheel Drive	CVT Automatic with Reverse
CHAIN SIZE	
	#50 5/8" Pitch
TIRES & WHEELS	
Front	17 x 7 - 8 @ 15 p.s.i.
Rear	18 x 9.5 - 8 @ 15 p.s.i.
ADVANCED GEOMETRY SUSPENSION	
Front	Double A-Arm with Adjustable Coil Over Damped Shocks
Rear	Swing Arm with Adjustable Coil Over Damped Shocks
STEERING	
Type:	Rack and Pinion

FRAME	
Type - Heavy Gauge - Jig Welded	1.25" Main Frame
Rear Axle	1.25" Hardened Alloy Steel
Finish	Baked Powder Coat
BRAKES	
Type: Rear	8.75" Hydraulic Disc with Parking Brake
PERFORMANCE	
Max Speed Approx.	Up to 39 mph (optional speed reducer available - 20 mph)
Fuel Consumption	Up to 50 mpg
SPECIAL FEATURES	
Adjustable slide bucket driver seat, fixed bucket passenger seat, 3 point shoulder/lap belts with retractor, dual engine stop switch, 1-1/4" full brush bars, steerable front fenders, rear fenders, dual quartz halogen running lights, rear cargo rack, rear view mirror, speedometer, odometer, tilt wheel steering, plastic hood, whip flag, compliant to ASTM F2011. *20 mph speed reduction kit available (P/N 14573). Available mesh sun top.	
DIMENSIONS	
Curb Weight	475 lbs.
Maximum Rider Weight	400 lbs.
Seat To Pedals	34" - 39"
Wheelbase	57"
Vehicle - Overall	83.2"L x 53.4"W x 53.75"H
Climbing Angle	20 - 25°

7151 ELECTRICAL SCHEMATIC

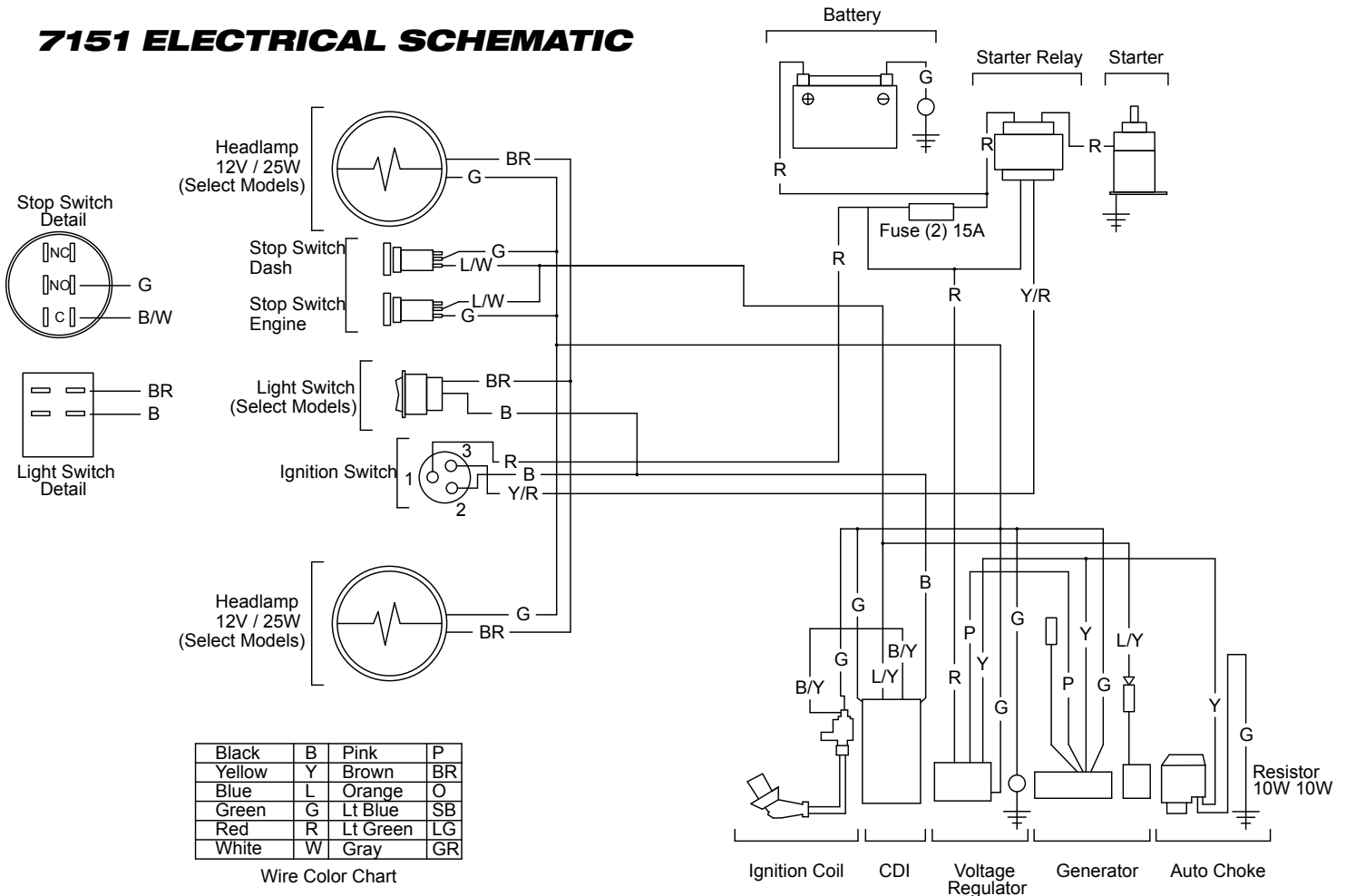



7625 DiSalle Boulevard
Fort Wayne IN 46825

62194 Commercial Street
Roseland, LA 70456

Toll Free 800-643-7332
Fax 800-399-1399
www.amsportworks.com